

DL-38

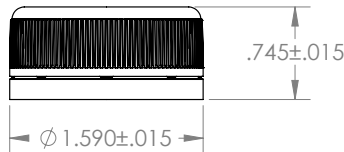
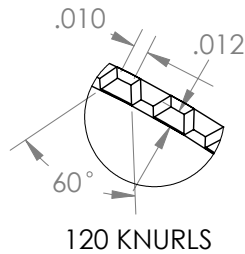
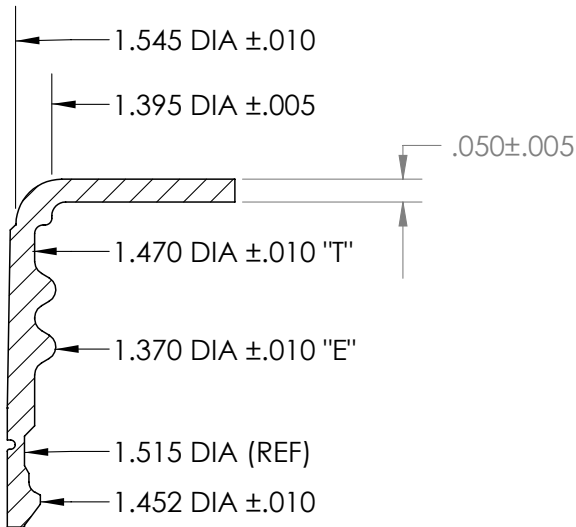

MARKETS

- Food and Beverage
- Medical and Pharma
- Automotive
- Industrial
- Nutraceutical

PRODUCT APPLICATIONS

- Kombucha
- Non-Carbonated Beverages
- Automotive Products
- Industrial Products
- Vitamin
- Dry Product

ADVANTAGES

- Can be run across multiple bottle materials
- Multiple lining options for various filling applications
- Customizable for your brand
- Band separation for tamper evidence

CLOSURE SPECS

- Weight: 4.2gms
- Diameter: 38mm
- Height: 18.92mm

DISC LINING MATERIAL OPTION

- SS-222 Foam
- EVA
- Foil Induction Seal

NECK FINISH

- PE-1787
- PP-1763
- Glass-1768

CLOSURE SEAL OPTION

- Disc Liner

BOTTLE TYPE

- Glass
- PET
- HDPE

RESIN TYPE

- PP

FILLING PROCESS

- Cold Fill
- Ambient
- Hot Fill

CAP PACKING SPECS (PIECES)

- Carton: 1,872
- Pallet: 39,312 (3 layers)
- Truck Load: 2,358,720 (60 pallets)
- Carton: 19.25 x 12.75 x 14.5

