

DL-28

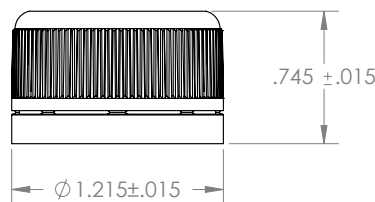
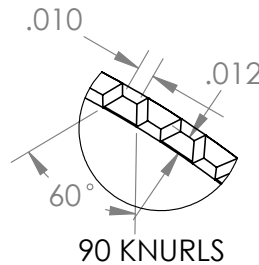
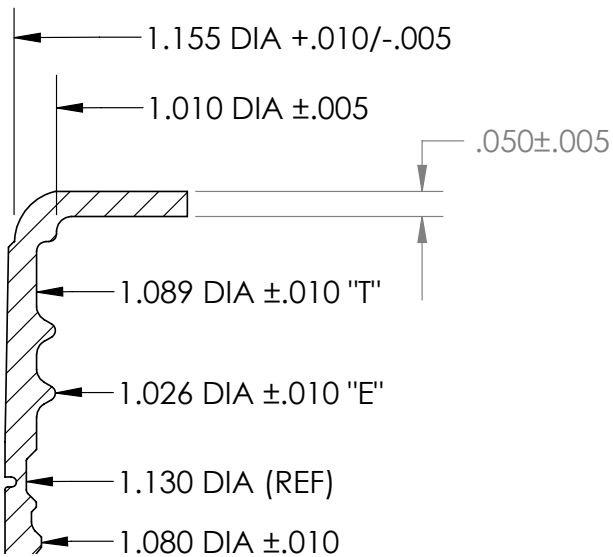

MARKETS

- Food and Beverage
- Medical and Pharma
- Automotive
- Industrial

PRODUCT APPLICATIONS

- Maple Syrup
- Motor Oil

ADVANTAGES

- Can be run across multiple bottle materials
- Multiple lining options for various filling applications
- Customizable for your brand
- Band separation for tamper evidence

CLOSURE SPECS

- Weight: 2.8gms
- Diameter: 28mm
- Height: 18.92mm

DISC LINING MATERIAL OPTION

- SS-222 Foam
- EVA
- Foil Induction Seal

NECK FINISH

- PE-1787
- PP-1763
- Glass-1768

CLOSURE SEAL OPTION

- Linerless Plug Seal
- Disc Liner

BOTTLE TYPE

- Glass
- PET
- HDPE

RESIN TYPE

- PP

FILLING PROCESS

- Cold Fill
- Ambient
- Hot Fill

CAP PACKING SPECS (PIECES)

- Carton: 3,168
- Pallet: 66,528 (3 layers)
- Truck Load: 3,991,680 (60 pallets)
- Carton: 19.25 x 12.75 x 14.5



RIGID